

M15WM



FEATURES

- // Capable of 1,450 Lbs. of clamp force
- // Designed to fit inside an 8"-10" diameter wheel
- // Available as a complete system, aluminum caliper, ductile cast iron bracket & hub/disc
- // Simple single piece caliper bridge design
- // Choice of CW or CCW lever actuation
- // Minimum moving parts to wear out



SPECIFICATIONS

WEIGHT	2.5 Lbs.
ROTOR DIAMETER	6" To 8"
ROTOR THICKNESS	.188"
LINING TYPE	Non-Asbestos Organic
TOTAL LINING AREA	2.9 Sq. In.
USABLE LINING THICKNESS PER PAD	.125"

Specifications are guidelines only and subject to change. Consult Hayes Performance Systems for specific model, part number, and assembly drawings - contact@hbpsi.com.

REFERENCE DIMENSIONS

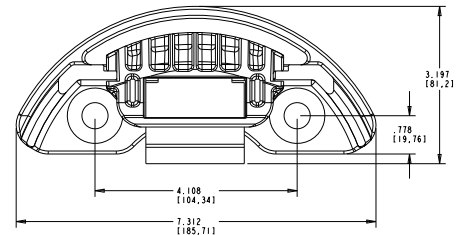

TORQUE INFORMATION

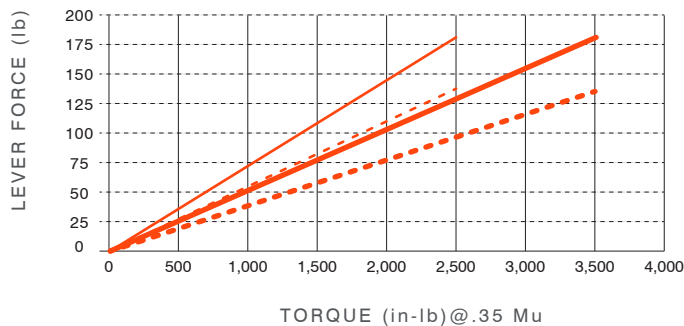

- Dia = 6 in, Lever length = 3 in
- - - Dia = 8 in, Lever length = 3 in
- · · Dia = 6 in, Lever length = 4 in
- · - · Dia = 8 in, Lever length = 4 in

