

M100SA

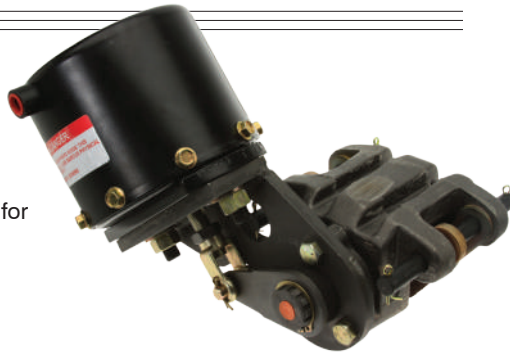

FEATURES

- // Capable of 10,000 Lbs. of clamp force
- // Self adjusting for friction pad wear
- // Fully sealed internal ball ramp mechanism
- // Fully assembled, with air chamber mounted for either CW or CCW operation
- // Quick change pads, retained by mount pins
- // Fast response - capable of 100 milliseconds
- // Chamber can be positioned in 120 degree increments
- // Mechanical release using a wrench



SPECIFICATIONS

WEIGHT	36.5 Lbs.
ROTOR DIAMETER	10" - 40"
ROTOR THICKNESS	.375" - .750"
LINING TYPE	Non-Asbestos Organic, Sintered
TOTAL LINING AREA	14.8 Sq. In.
USABLE LINING THICKNESS PER PAD	.470"

Specifications are guidelines only and subject to change. Consult Hayes Performance Systems for specific model, part number, and assembly drawings - contact@hbpsi.com.

REFERENCE DIMENSIONS

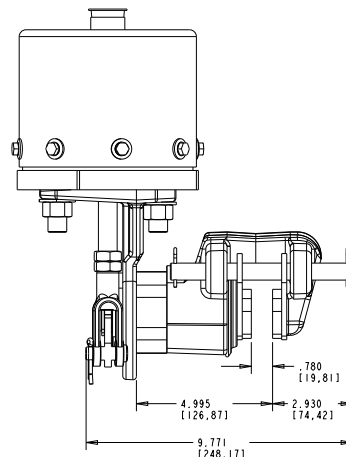
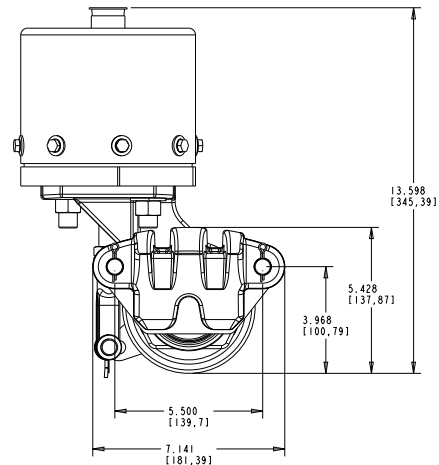

TORQUE INFORMATION

